



E-LookTM **Express**

PANEL FITMENT SYSTEM

INSTALLATION INSTRUCTIONS



CAB COMPONENTS TO BE INSTALLED

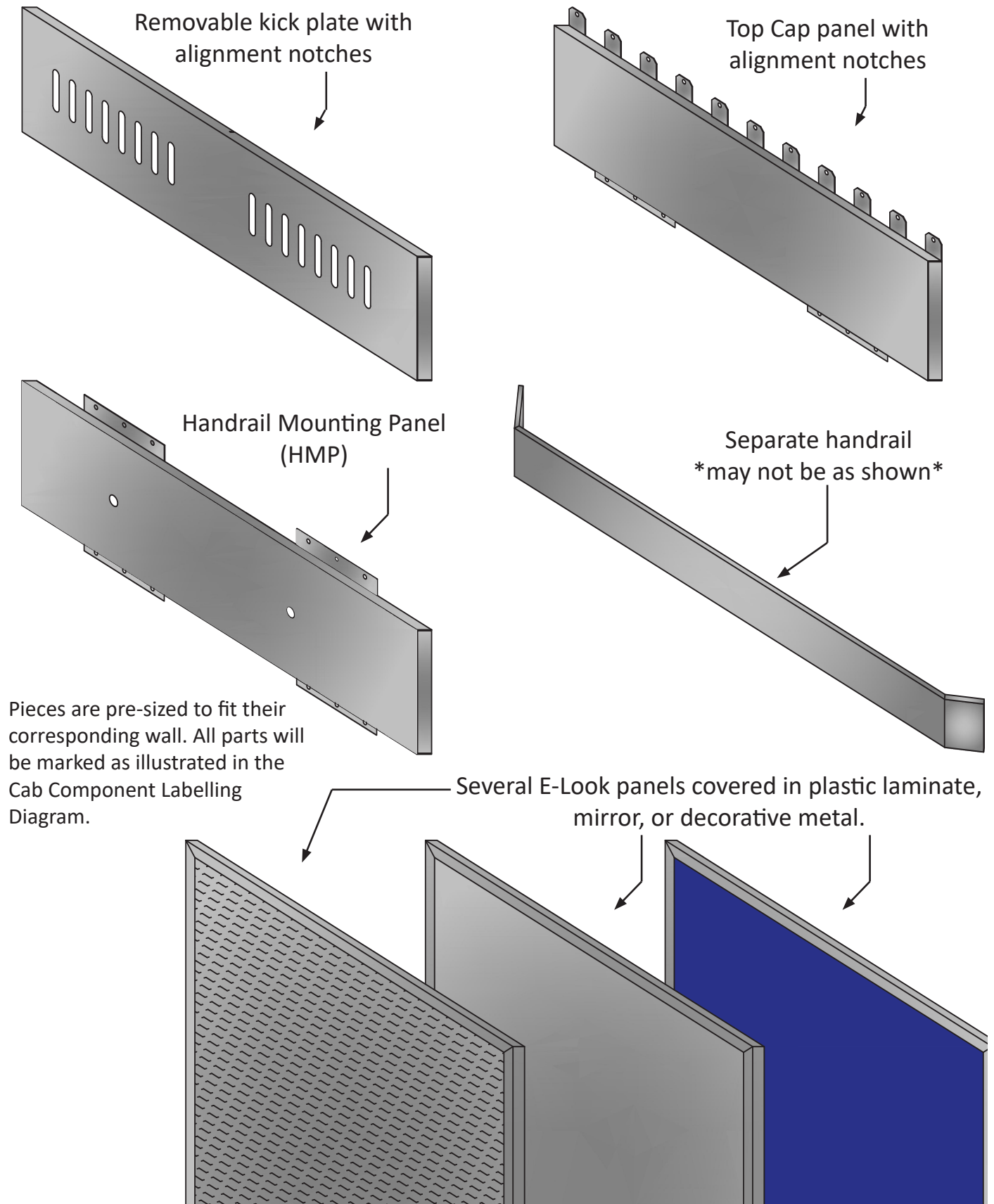

TOOLS REQUIRED

- Measuring Tape
- Drill
- Frame Square
- Ladder
- 2" or 3" Paint Brush for Latex Paint
- Caulking gun

CAB COMPONENT LABELLING

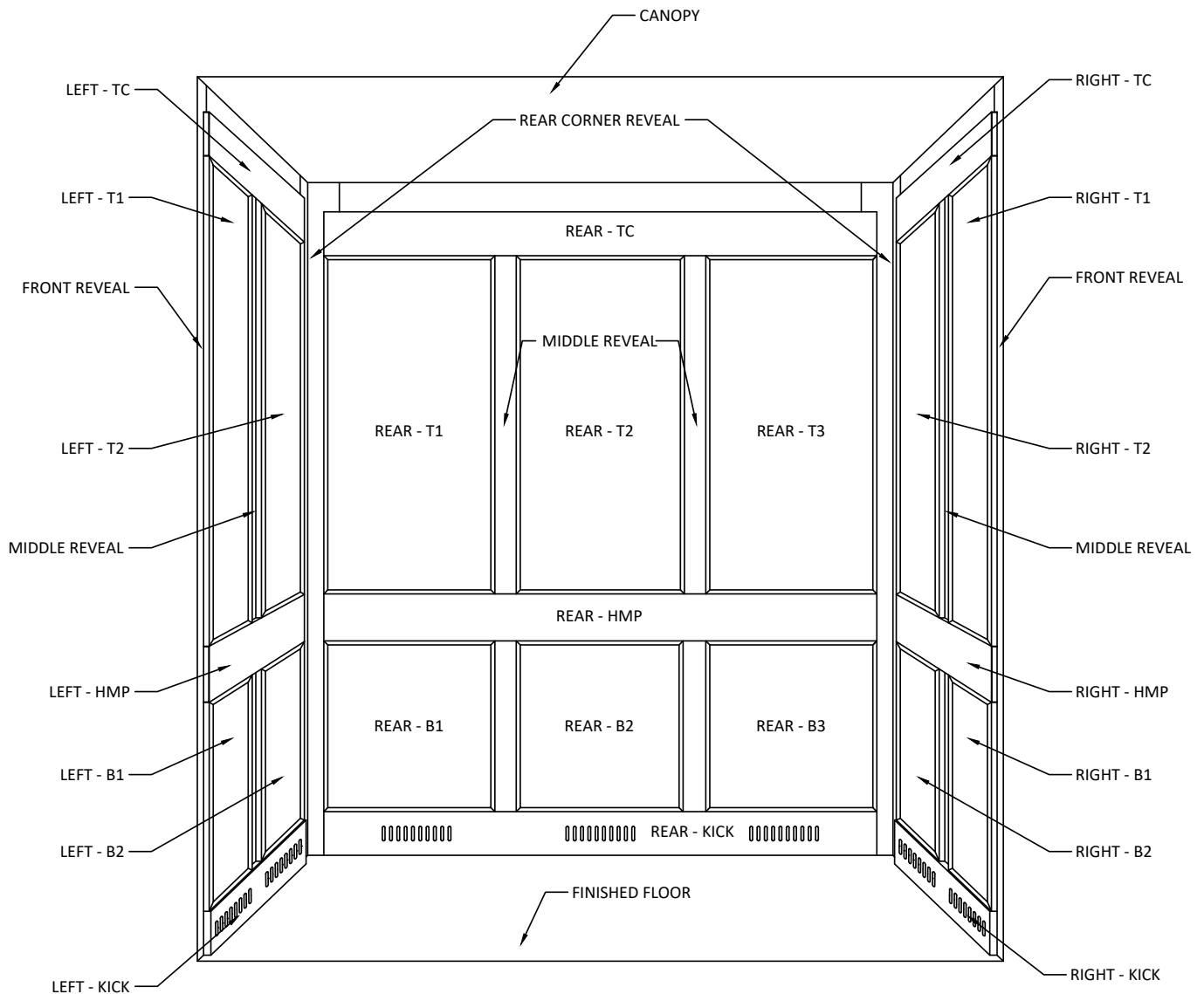

Dia .1

SECTION 1: UNPACKING

- 1.1. When your new E-Look™ cab arrives, transport it near to the cab you will be renovating and organize the crates so that they will be easily accessible.

The crates contents are itemized on its surface.

One box will be labelled “Open First”. It contains the drawings, instructions, hardware & adhesive.

- 1.2. Carefully un-crate the cab package, making sure that none of the components are damaged.
- 1.3. Check the colours, features, and dimensions of the components against your order before you begin removing the existing elevator interior.
- 1.4. Note the labeling on the components on the previous page. The labels indicate the order in which the components will be installed and will help you identify the correct component called for in the instructions.

If you have any questions at this point, contact ECR before going ahead with any part of the installation.

For technical support on the E-Look Panel installation, please contact us at:

Elevator Cab Renovations
Office: (613) 745-4870
Toll Free: 1-877-745-4870
ecr@elevatorcabs.ca

Office Hours : 6:30 AM to 3:30 PM Eastern Standard Time

SECTION 2: PREPARE SITE FOR INSTALLATION

- 2.1. Remove all materials being replaced from the existing cab, stripping the cab down to the bare shell. Clean any debris and oil from the cab shell.
- 2.2. If the drop ceiling is being replaced, paint the perimeter of the canopy 4" in from all sides with matte black latex paint (paint is not included). The remainder of the canopy will not be visible once the new ceiling is installed.
- 2.3. If the floors are being replaced, remove existing floor and install new flooring before installing the E-Look panels. If the floors are not being replaced, use a protective covering to prevent damage to the floor.

SECTION 3: INSTALL CAB REVEALS

- 3.1. Dry fit the front reveals and trim reveals as necessary. Reveals can be up to 1/4" short of the canopy without affecting the final look of the cab (Dia. 3).
- 3.2. If your shell has a protruding header, split the reveal where the step occurs and fit the remaining reveal piece against the step as indicated by the red dashed line (Dia. 3).
- 3.3. Apply the supplied 2-sided tape to the back side of the reveals.

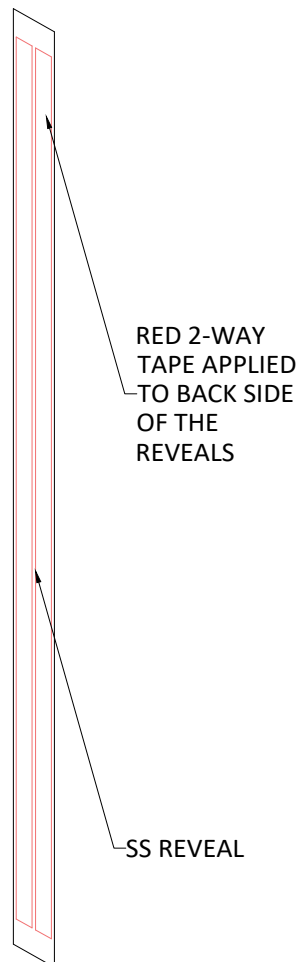

Dia .2

SECTION 3: INSTALL CAB REVEALS

- 3.4. Starting at the bottom press the reveals onto the cab shell, ensuring a tight fit against the front and flush to the floor. Apply pressure to ensure the reveal adheres to the cab shell.
- 3.5. Fit and install the vertical reveals in their corresponding location according to the drawings. The reveals are cut 4" wide to provide a visible 2" reveal with 1" extra on each side under panels. The reveals are oversized so it is not necessary to install them perfectly centered (Dia. 3).
- 3.6. A drop ceiling will block the canopy from view; if your cab has a drop ceiling, or a drop ceiling was purchased, paint the shell walls below the canopy and between the reveals with matte black latex paint (not included). The top cap normally sits 4 inches below the canopy; paint at least 5 inches below the canopy (Dia. 3).
- 3.7. If the top cap will be visible, stainless steel horizontal reveals will be included. Fit the reveals tight against the canopy between the corners and front reveals, trimming if necessary. Apply the reveals to the shell with 2-sided tape.



Note: The middle reveals extend past the Top Cap but will not touch the canopy. If your cab has an exposed Top Cap, the middle reveals must be trimmed (if necessary) to fit between the shell floor and the bottom of the horizontal reveals.



Note: It is important to remove the protective plastic from the reveals before continuing the installation. Once the kick plates are installed the protective plastic is difficult to remove.

SECTION 3: INSTALL CAB REVEALS

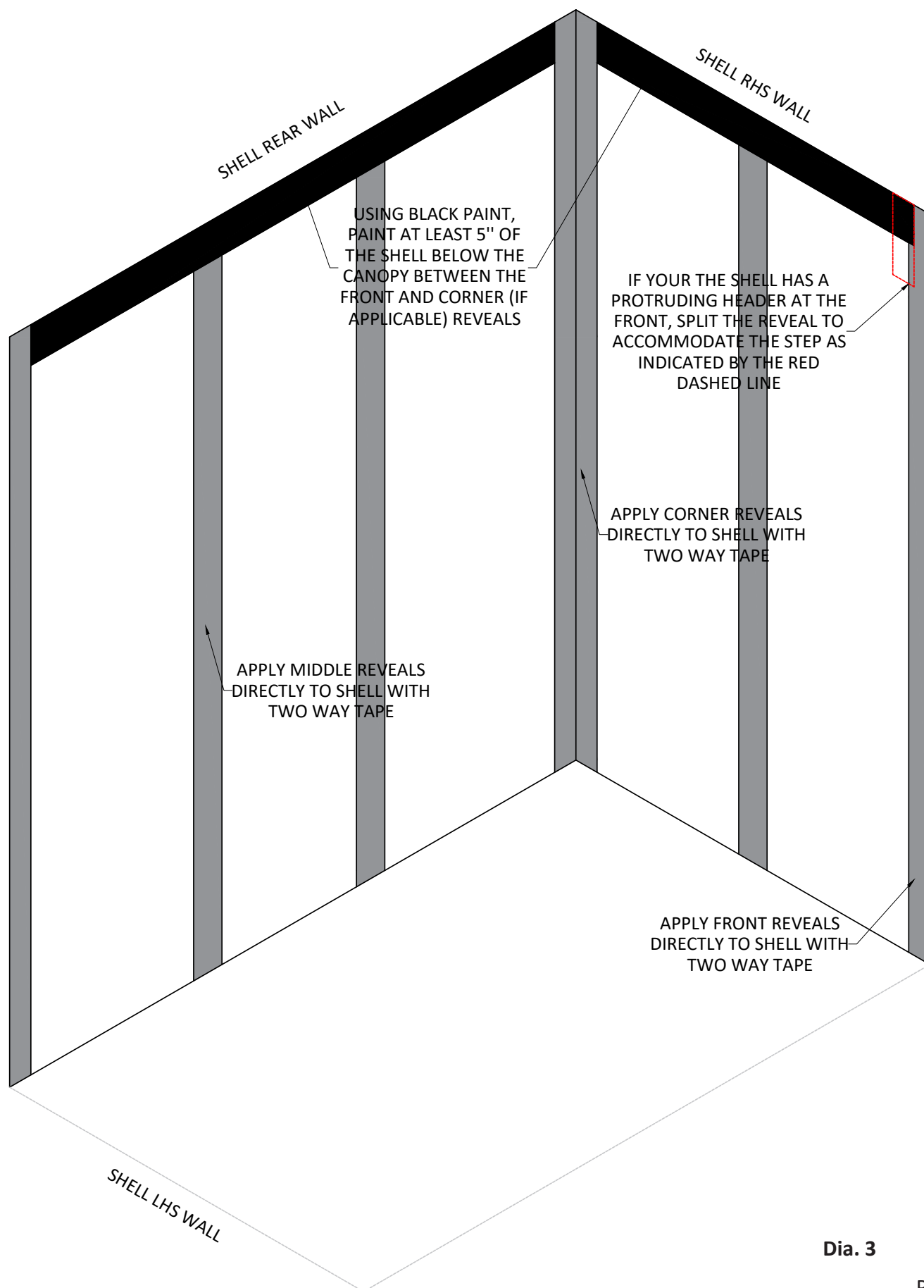

SECTION 4: INSTALL E-LOOK PANEL SYSTEM

- 4.1. Measure the width of each wall and determine the center point. Mark a line vertically at this point (Dia. 4).
- 4.2. Removable vented kick plates are provided with a centering notch; locate this notch and align it with the center of the shell.



Note: The bottom of the kick plate should sit on or slightly above the finished floor. If no floor currently exists, simulate the finished floor height with an appropriate build out or shims before installing kick plates.

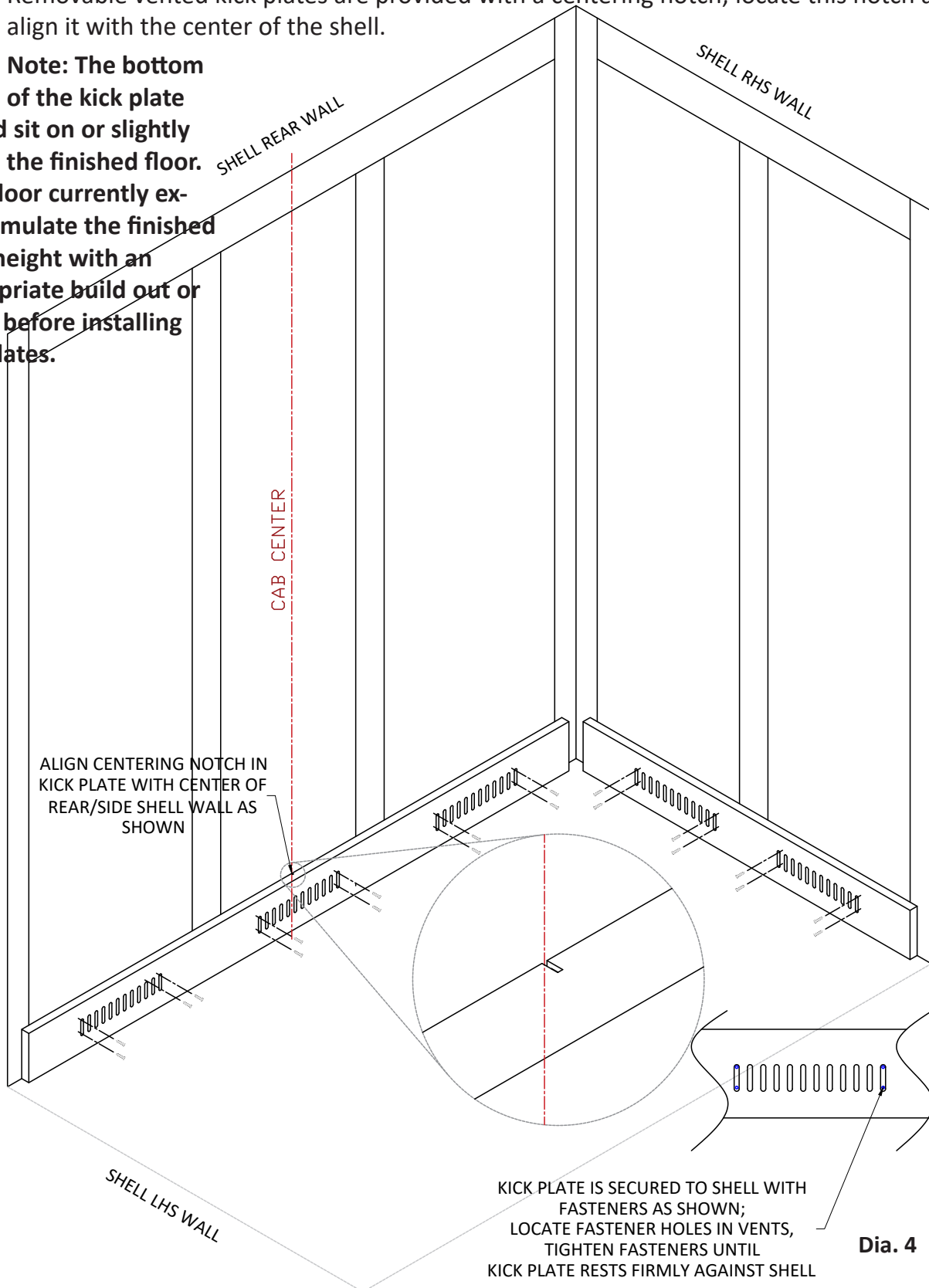

SECTION 4: INSTALL E-LOOK PANEL SYSTEM (CONTINUED)

- 4.3. Center the kick plate on the back wall and fasten the kick plate to the wall using the mounting holes located inside the vent slots with tap screws provided (Dia. 5).



Note: At this point it is crucial to check that kick plates are square to adjacent walls and ensure that all kick plates are the same height on all three non-access walls before installing the panels.



Note: It is important to remove the protective plastic from the back, top and bottom of the kick plates prior to installation. Once installation is complete these areas are no longer accessible.

- 4.4. If additional vent holes are required, refer to the included **Universal Baffle Strip Installation Manual** for more information and instructions on how to create additional ventilation in the cab shell.

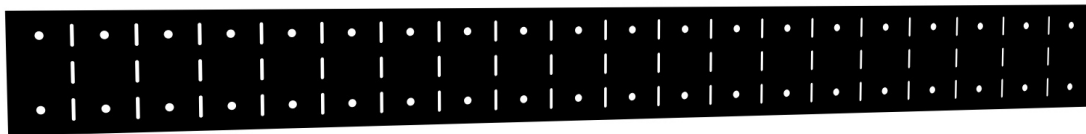

Dia. 5
Universal baffle strip.

- 4.5. Determine panel spacing (refer to drawings; typically 2" between panels and 2" from shell walls). The E-Look panels will have a foam backed two-sided VHB tape pre-applied to the back of the vertical trims. To ensure proper fit, dry fit the panels into their appropriate location.



Note: Ensure the shell is prepped to adhere E-Look panels (remove any debris, grease, adhesives etc).



Note: Dry fitting the panels and ensuring proper placement is recommended. Relocating the panels once the two way tape is seated is not recommended and will result in damage to the panels and reveals.

- 4.6. Once satisfied with the fit, note the location of the edge of the panels.

SECTION 4: INSTALL E-LOOK PANEL SYSTEM (CONTINUED)

4.7. The panels are mounted using a combination of two-way tape, adhesion promoter (primer) and an MS Polymer Construction Adhesive. For best results, follow these steps:

- 1) Dry fit the panels and note their proper location.
- 2) Determine the application points for the construction adhesive.



Note: Construction adhesive is applied in a blob format in 1.5" diameter with sufficient thickness to span the gap between the panel and the shell (about 3/8" thick). The typical application is four blobs on the lower (smaller) panels and six to eight blobs on the upper (larger) panels.

- 3) Apply adhesion promoter to the back of the panels corresponding to each of the application points of the construction adhesive. It is important to apply the adhesion promoter to the panel prior to the application of the construction adhesive.
- 4) Apply the adhesion promoter onto the shell wall. Prime the areas that correspond with the two-way tape and the construction adhesive on the panels.
- 5) The adhesion promoter must be allowed to flash off before applying the construction adhesive to the panels and before seating the two way-tape. The area with the adhesion promoter is ready once it appears hazy and feels tacky, but not wet (this process only takes a few minutes depending on site conditions).



Note: The adhesion promoter is the consistency of water (a little goes a long way). Care should be taken so that the primer aligns with the two way tape and will be covered once the panels are in place. Excess primer can be removed with acetone if required.

- 6) Once the adhesion promoter has flashed off, you can apply the construction adhesive to the panels. Perform this step in small batches to ensure you will have time to seat the panels before the construction adhesive has time to skin over.
- 7) Remove the adhesive liner from the Two Way tape. Align the panels into location and press into place to engage the tape and construction adhesive.

SECTION 4: INSTALL E-LOOK PANEL SYSTEM (CONTINUED)



Note: The primer is the consistency of water (a little goes a long way). Care should be taken so that the primer aligns with the two-way tape and will be covered once the panels are in place. Excess primer can be removed with acetone if required.

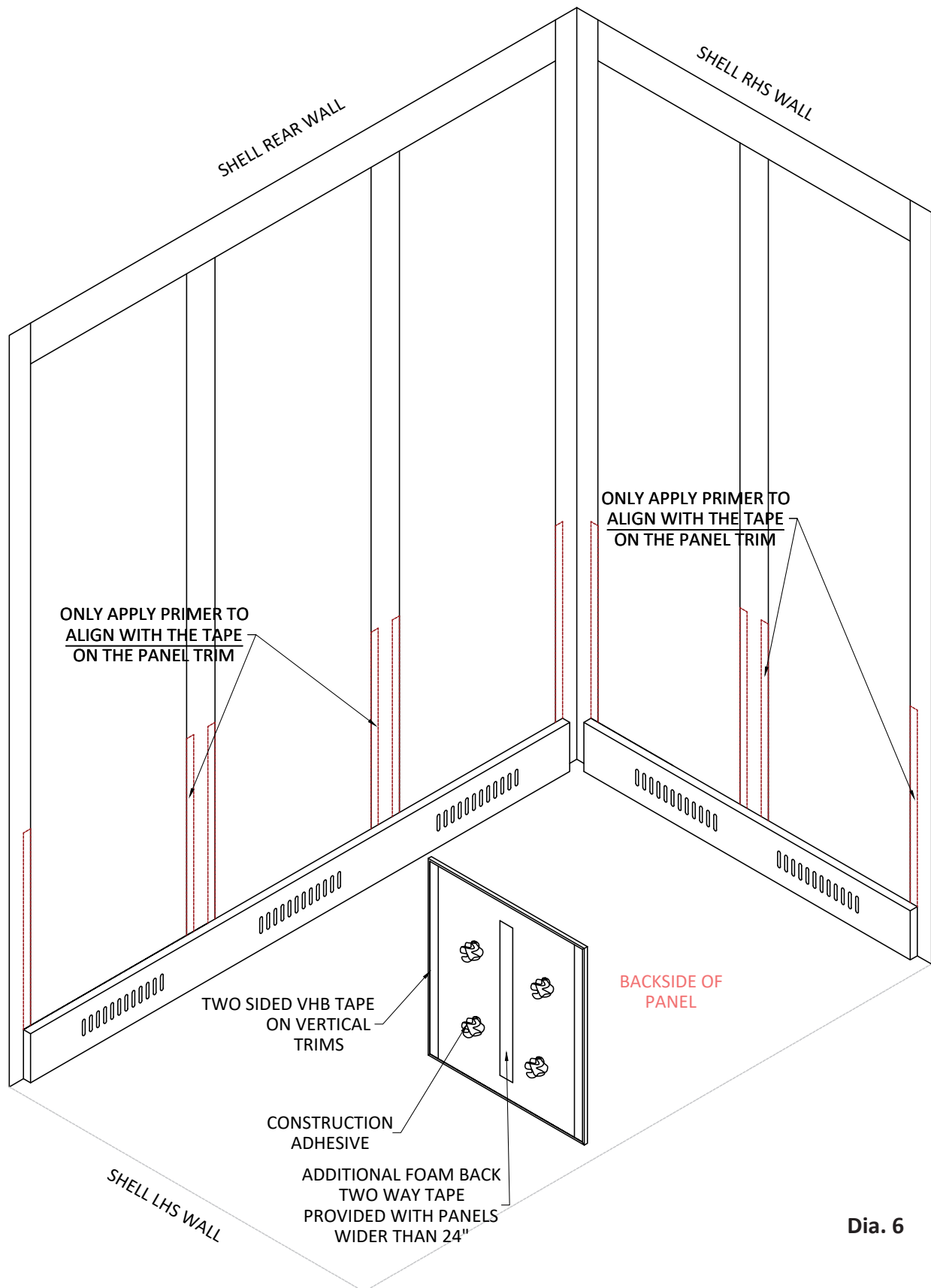

Dia. 6

SECTION 4: INSTALL E-LOOK PANEL SYSTEM (CONTINUED)



Note: The construction adhesive is primarily used to fill the void between the cab shell and the panel. The purpose is to remove any back and forth movement in the panel (oil canning) once the adhesive is cured.

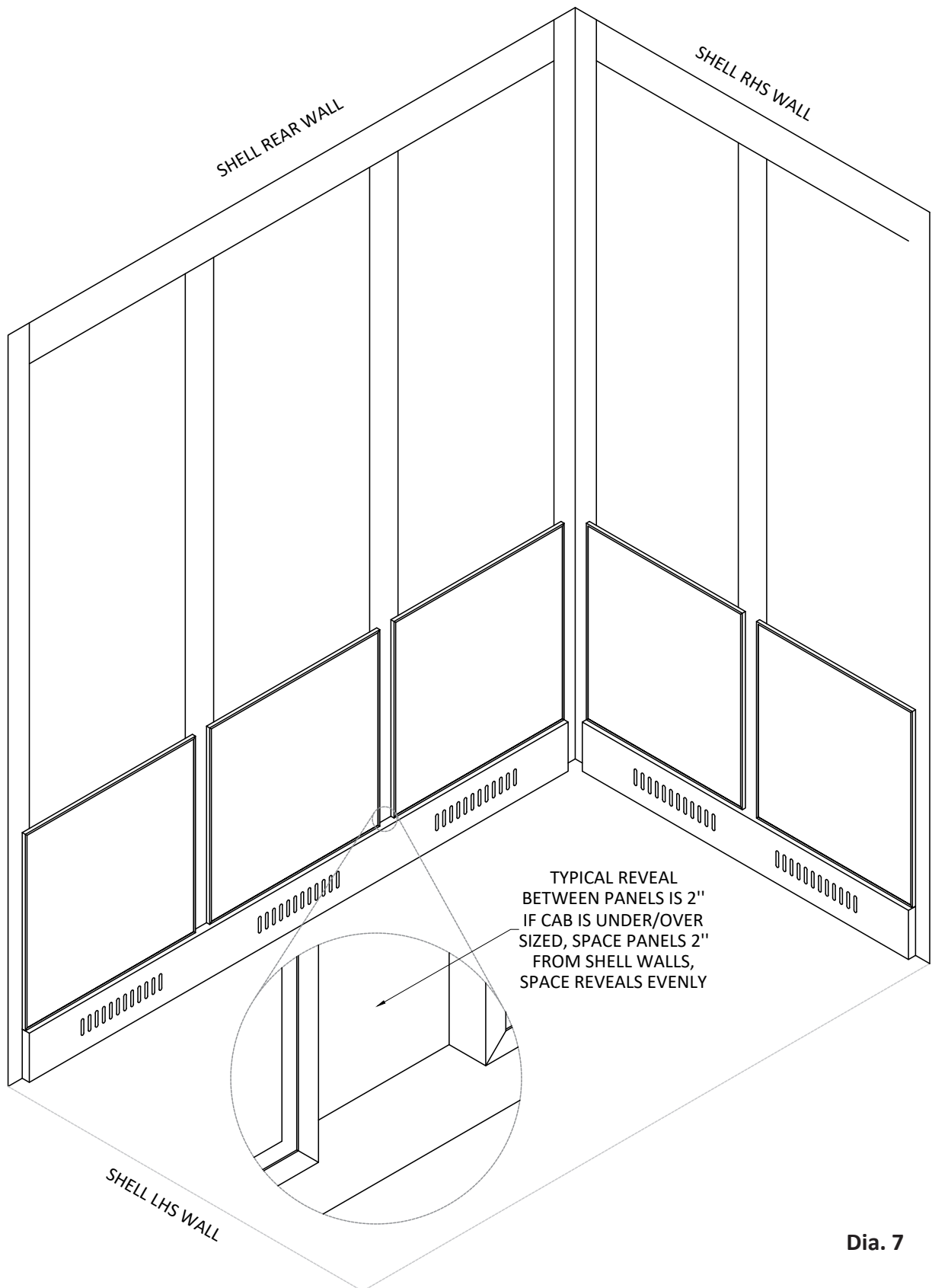

SECTION 4: INSTALL E-LOOK PANEL SYSTEM (CONTINUED)

- 4.8. Install the Handrail Mounting Panel by setting the tabs behind the previously applied panels; secure the panel in place by fasteneing the tabs above the panel through the shell.



Note: It is important to remove the protective plastic from the HMP prior to installation. Once the HMPs are installed the protective plastic is difficult to remove.

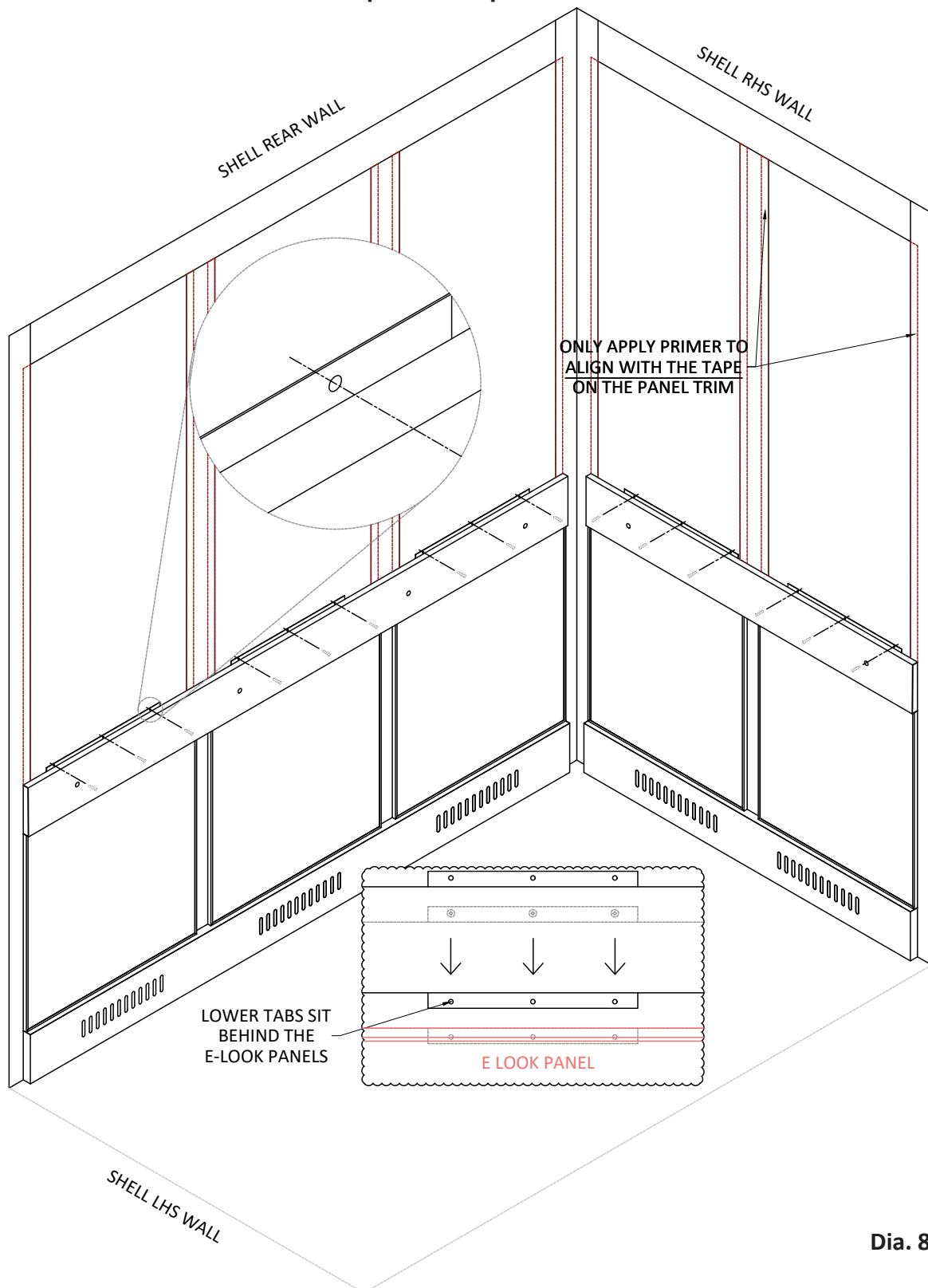

Dia. 8

SECTION 5: INSTALL HANDRAILS

- 5.1. Locate the pre-punched standoff locations in the HMP.
- 5.2. Drill 1/2" holes through the pre-punched holes through the substrate, through the cab shell.



Note: It is important to remove the protective plastic from the HMP prior to installation. Once the HMPs are installed the protective plastic is difficult to remove.

- 5.3. Insert and secure the provided togglers through the HMP and the shell.
- 5.4. Place the flared end of a stainless steel standoff against the handrail panel, centered on the toggler. Fasten this to the wall and HMP with the 1/4"-20 bolts provided.
- 5.5. Slide the inserts into the standoff (inserts are attached to the handrail).
- 5.6. Secure the handrail to the standoff using the set screws provided (Dia. 9).

Installing the Togglers

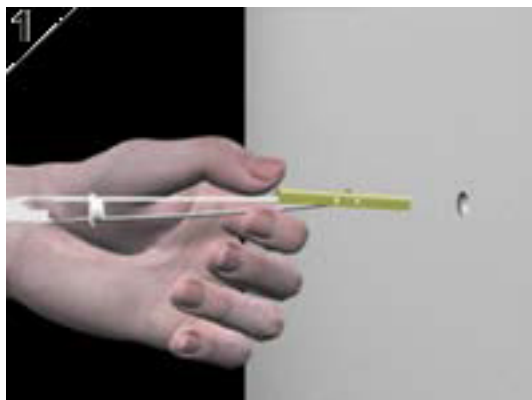

Drill a 1/2" hole. Hold the metal channel flat alongside plastic straps and slide channel through the metal channel through the hole. The minimum clearance behind the wall is 1 7/8".

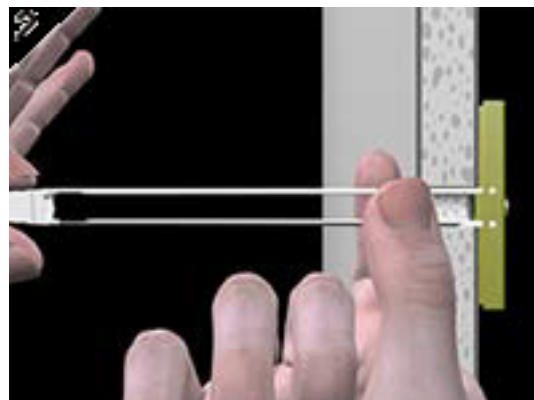

Hold the ends of straps between thumb and forefinger and pull toward you until channel rests flush behind wall. Slide plastic cap along straps with other hand until flange of cap is flush with the wall.

SECTION 5: INSTALL HANDRAILS (CONTINUED)

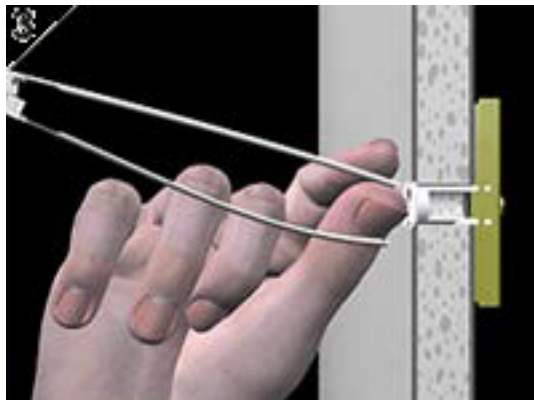

Snap straps at wall by pushing side to side snapping off straps level with flange cap.

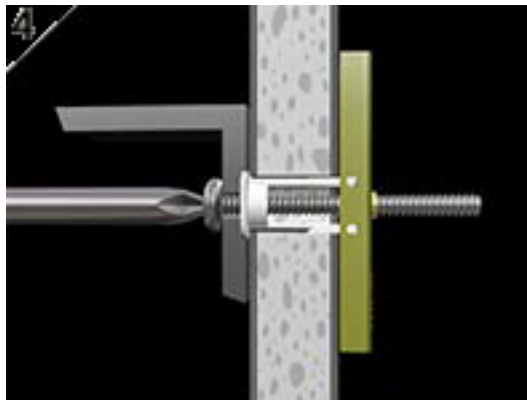

Place item over flange. Insert bolt through item and tighten until flush against item.

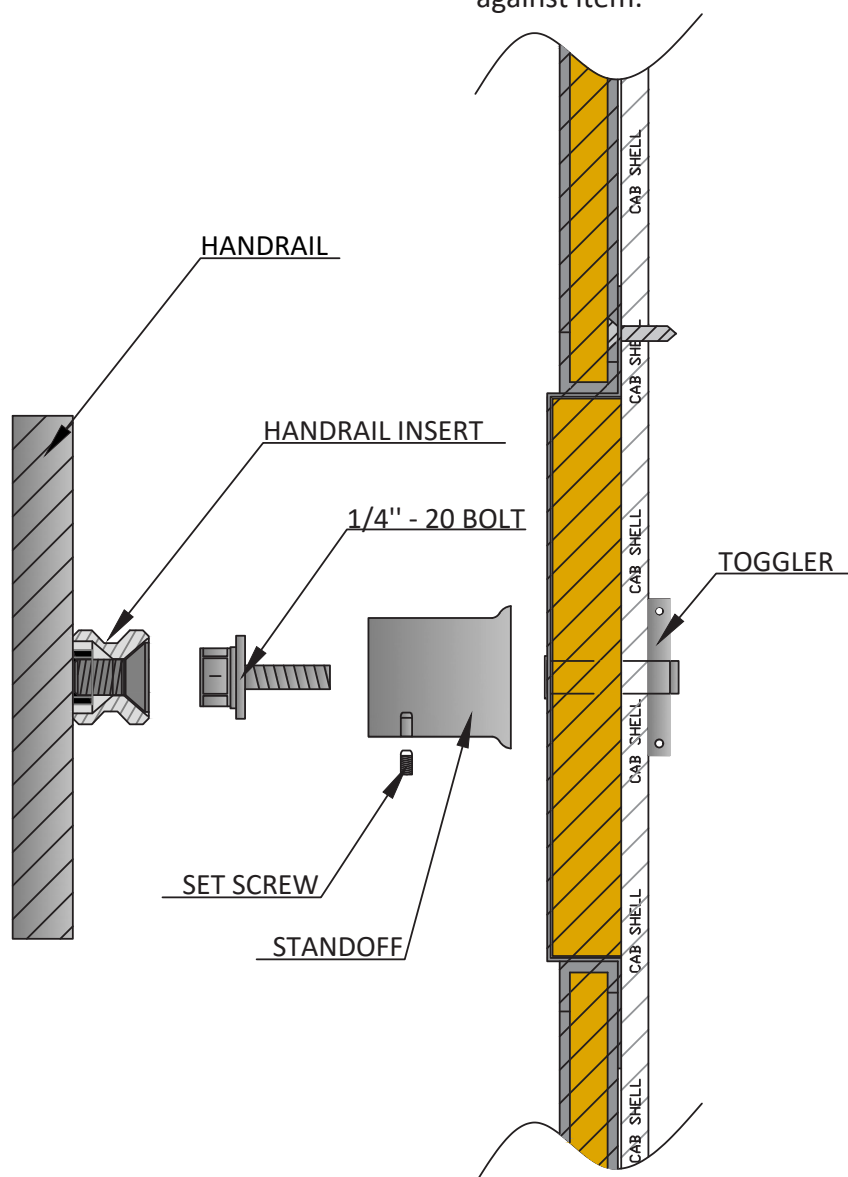

Dia. 9
Attaching standoffs to handrail.

SECTION 6: INSTALL E-LOOK PANEL SYSTEM (CONTINUED)

6.1. The panels above the HMP are installed as per section 4.5 and 4.7.



Note: Ensure the shell is prepped to adhere E-Look panels (remove any debris, grease, paint etc).



Note: Dry fitting the panels and ensuring proper placement is recommended. Relocating the panels once the two way tape is seated is not recommended and will result in damage to the panels and reveals.

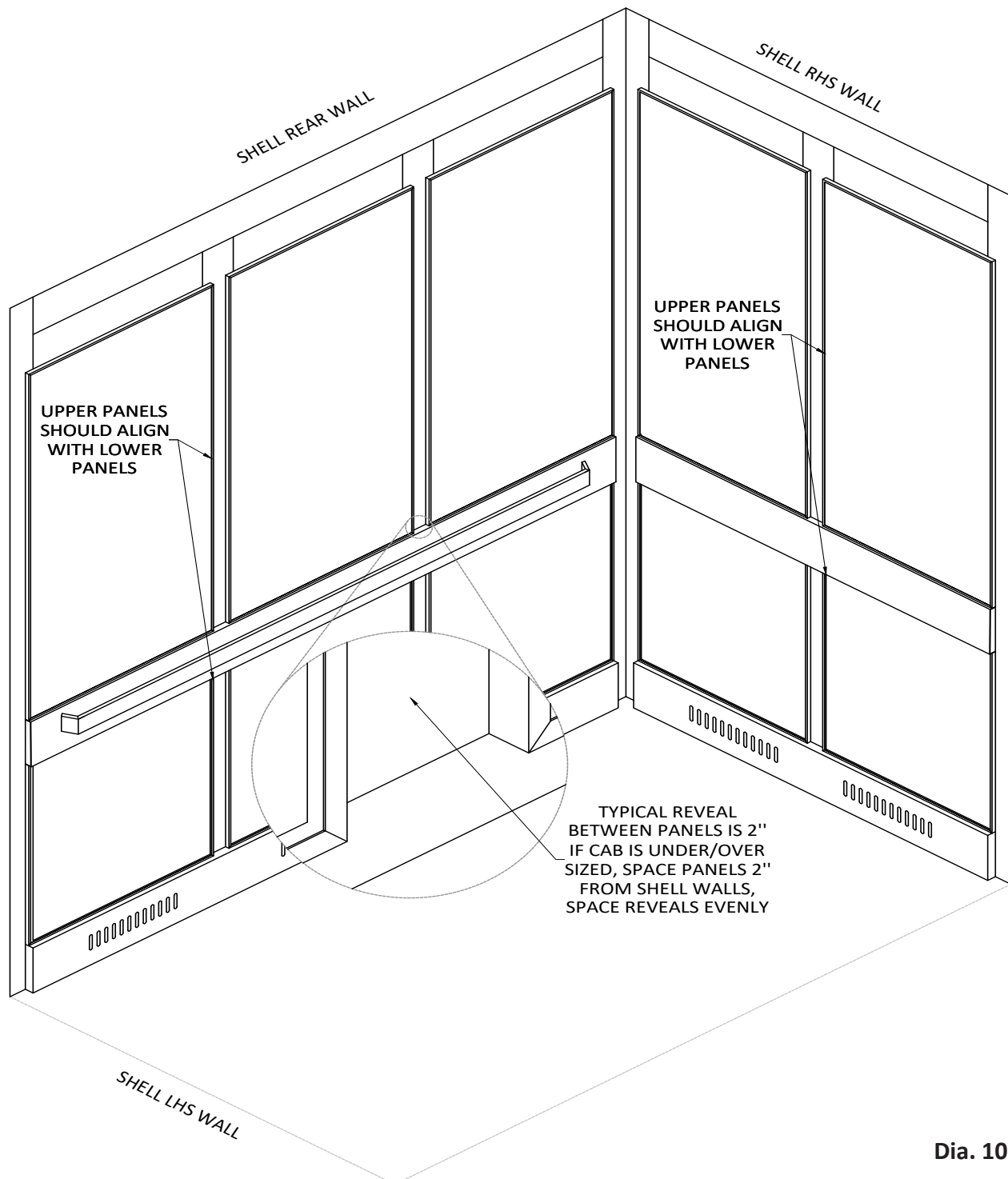

Dia. 10

SECTION 6: INSTALL E-LOOK PANEL SYSTEM (CONTINUED)

- 6.2. The Top Cap is installed similarly to the HMP. Set the tabs behind the E-Look panels and secure the Top Cap in place by fastening the upper tabs through the shell.

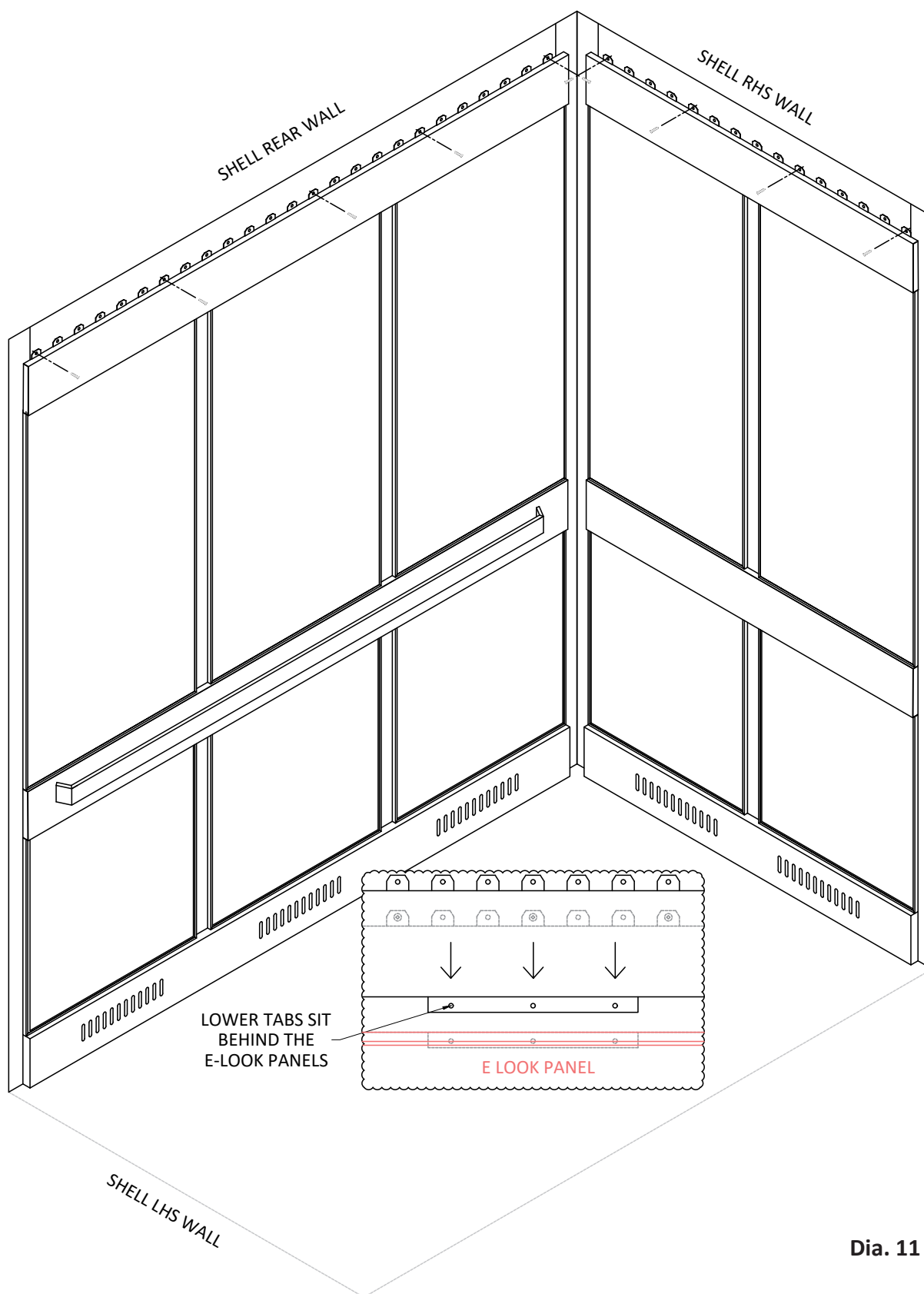

Dia. 11

SECTION 6: INSTALL E-LOOK PANEL SYSTEM (CONTINUED)

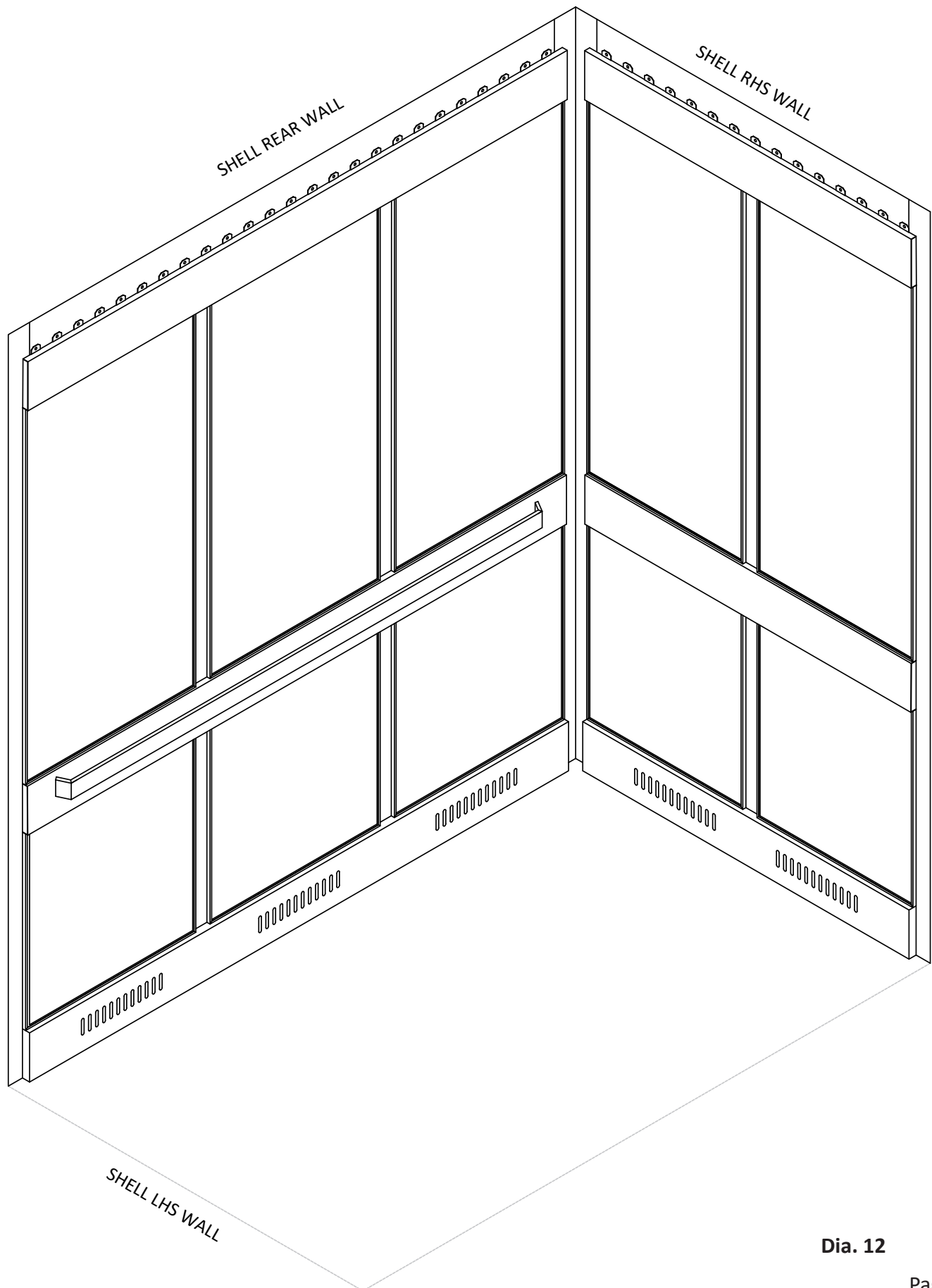

Dia. 12

SECTION 7: FINISHING TOP CAP

- 7.1. Ensure the Top Cap is secured to the shell. If necessary, use additional fasteners.
- 7.2. Install the removable SS pad hooks into top cap if required (Dia. 13).

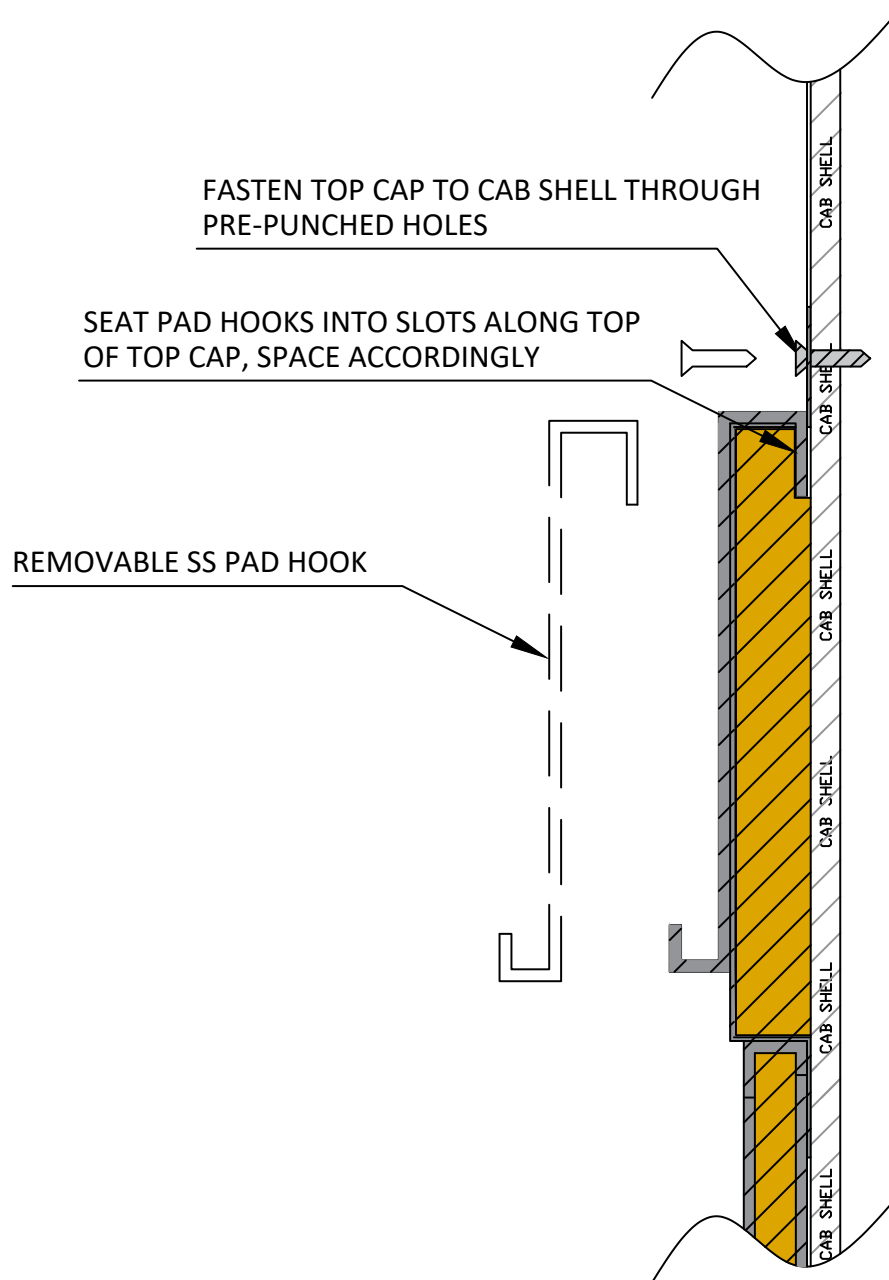

Dia. 13
Top cap detail.

SECTION 8: INSTALL ALTERNATE TOP CAP

- 8.1. If your cab does not have a drop ceiling, your Top Cap will arrive with a separate substrate. Apply the E-look panels to the shell before Top Cap installation, following the procedures outlined in section 4.
- 8.2. Fit and screw the substrates onto the shell wall ensuring a small gap is left between the top of the E-Look panels for the thickness of the Top Cap skin (Dia. 14).

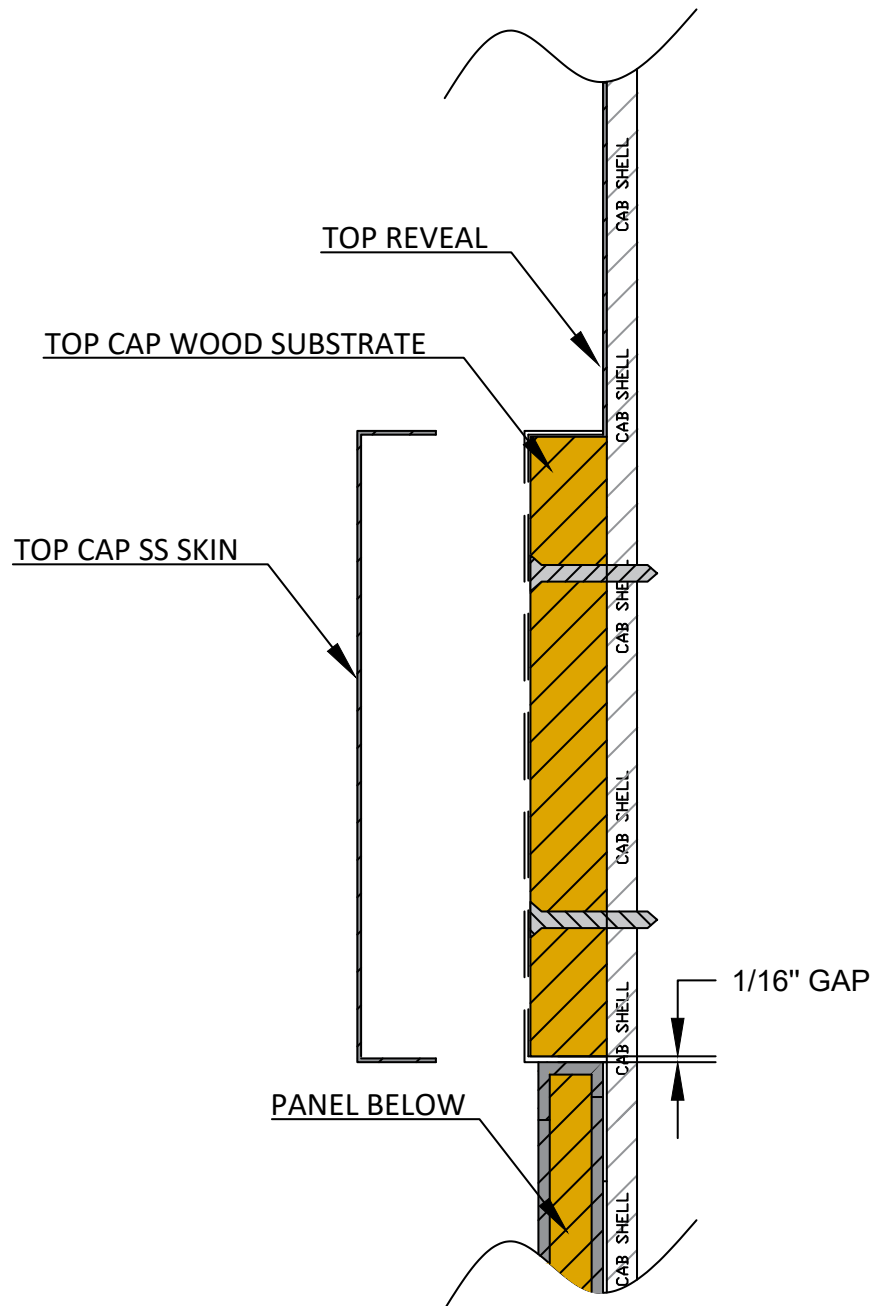

Dia. 14

Top cap detail (no drop ceiling).

SECTION 8: INSTALL ALTERNATE TOP CAP (CONTINUED)

- 8.3. Align the top cap with the panels and secure the skin to the substrate with two way tape (Dia. 15 through 17).

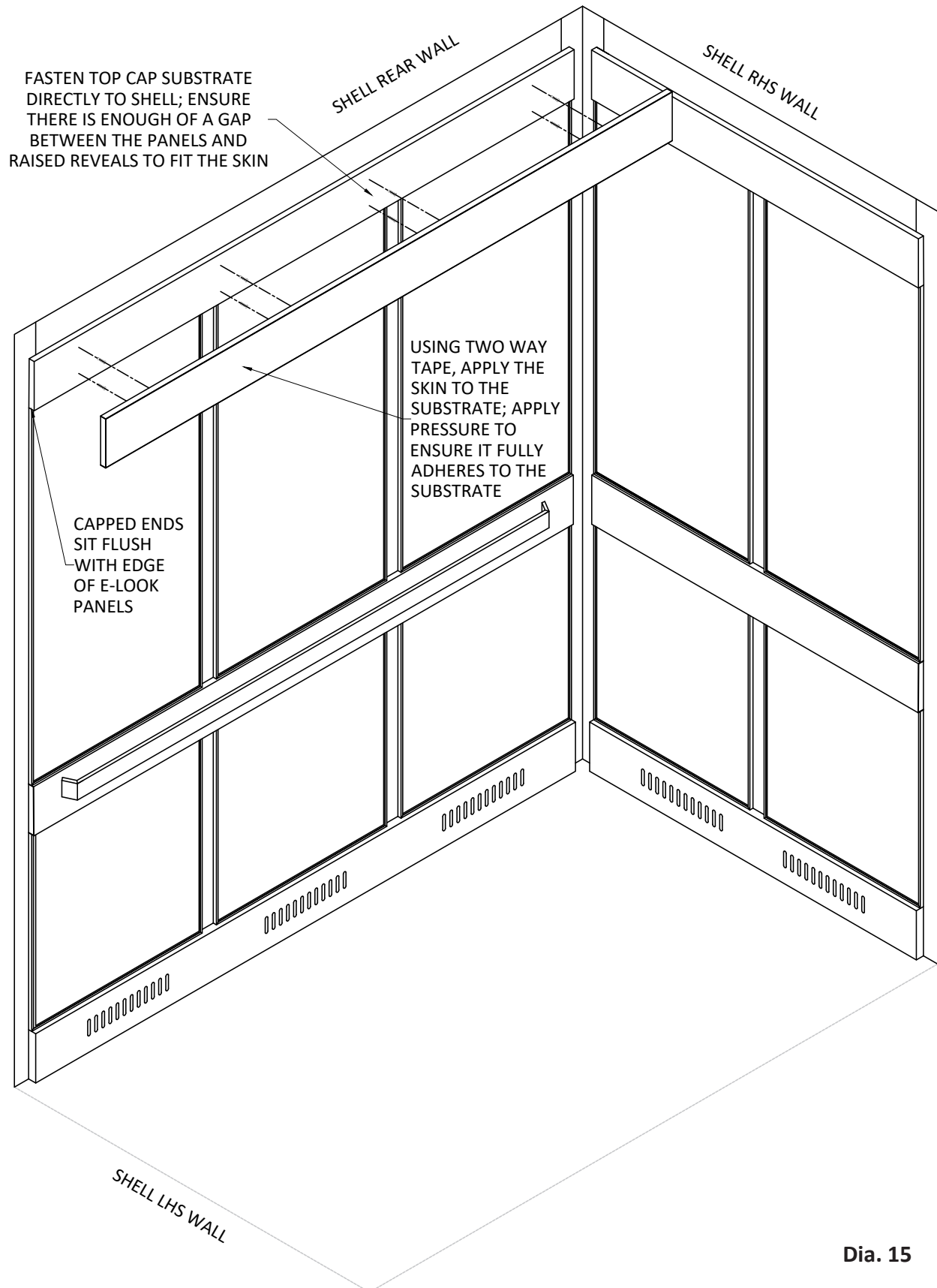

Dia. 15

SECTION 8: INSTALL ALTERNATE TOP CAP (CONTINUED)

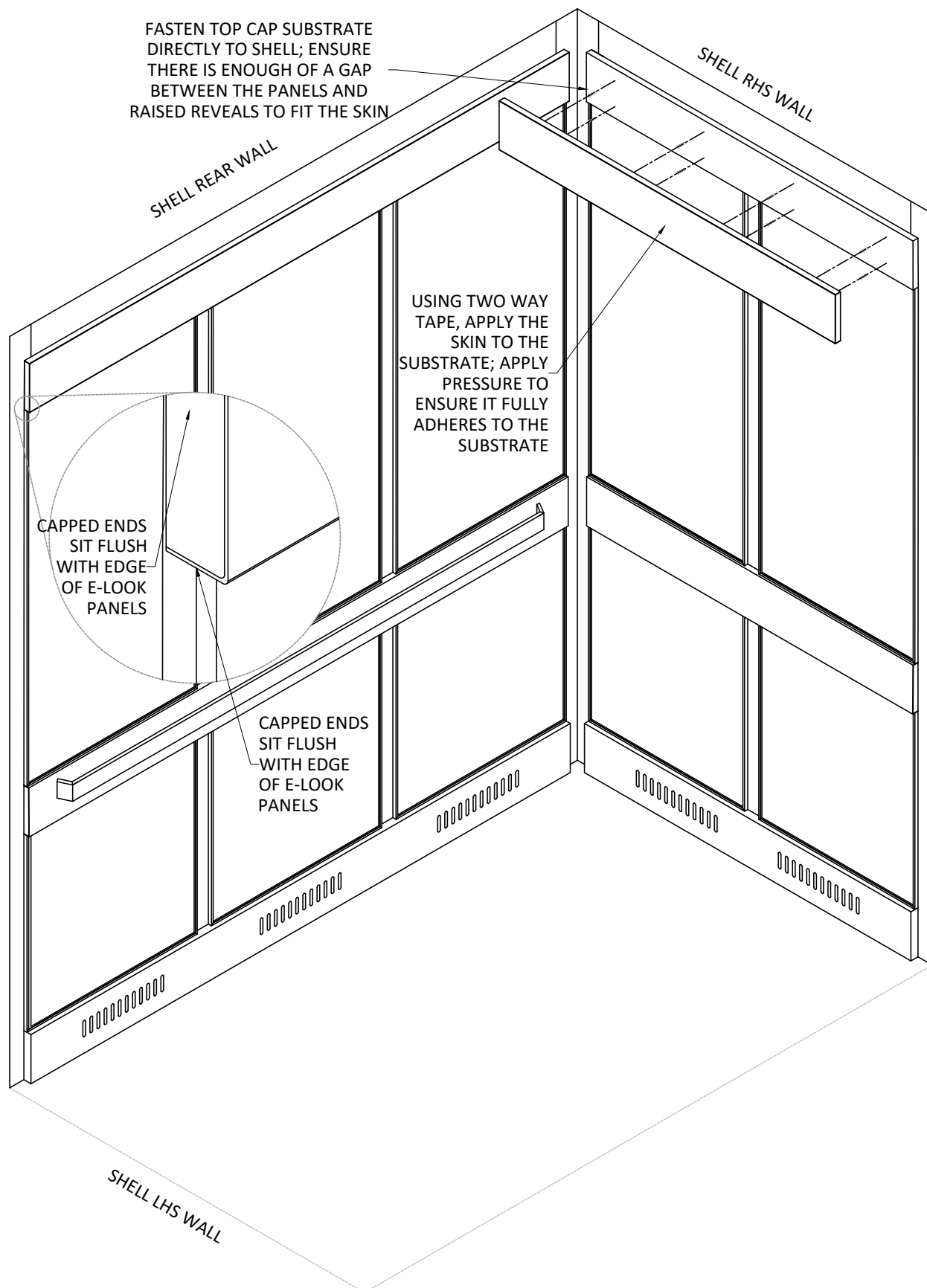

Dia. 16

SECTION 8: INSTALL ALTERNATE TOP CAP (CONTINUED)

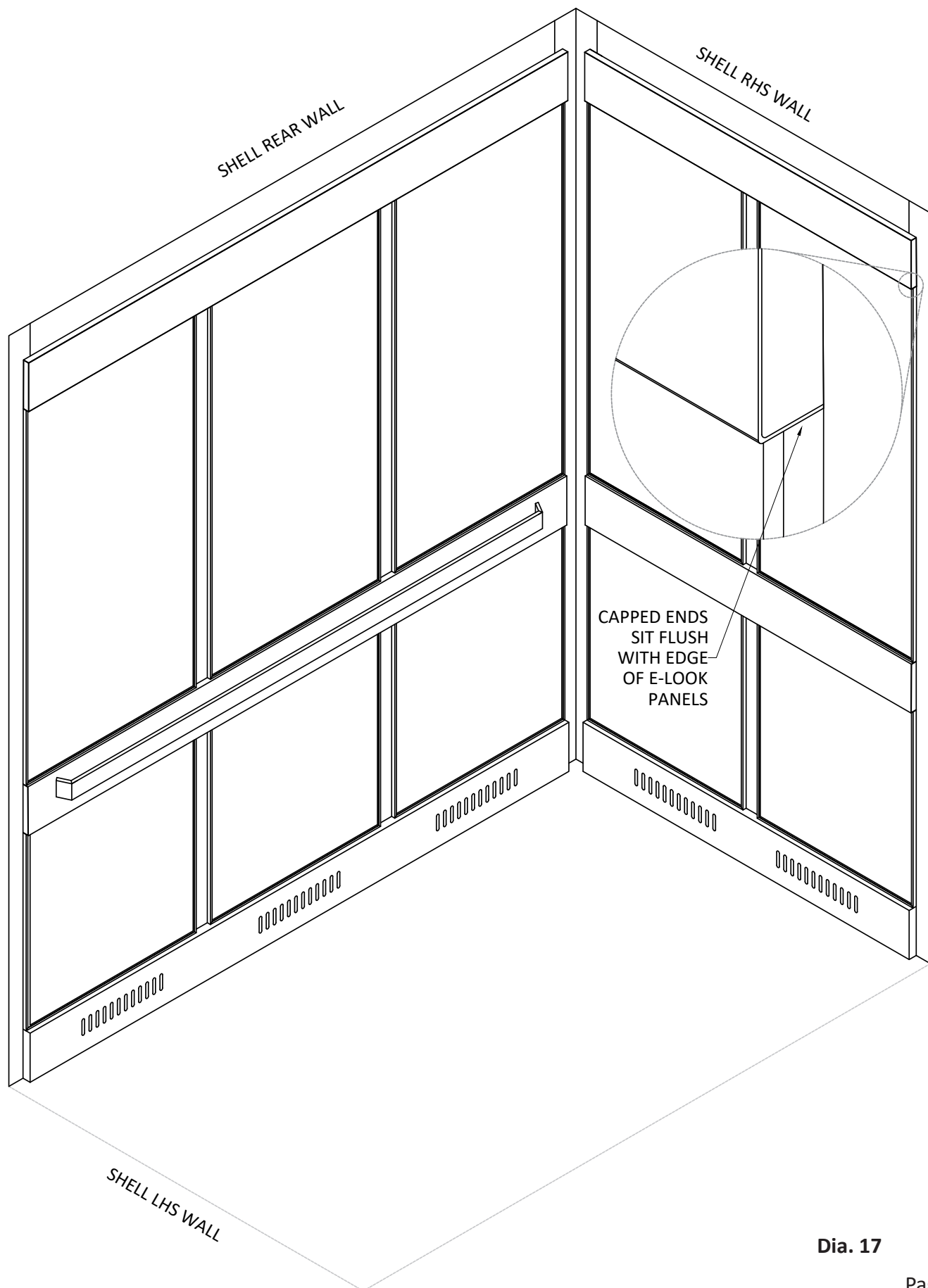

Dia. 17

GLOSSARY

Canopy:

The roof of the cab.

The top structural component of the shell.

The canopy houses the emergency hatch.

The canopy may have various electrical and mechanical components attached to its surfaces, both interior and exterior.

Non-Access Walls:

Any elevator cab wall which does not have an entrance.

Reveals:

Area of the elevator cab walls not covered by the panels. This area is usually covered with stainless steel or plastic laminate.

Strike Post or Slam Post:

Part of the door frame on which the door closes.

Return Panel

The wall of the cab adjacent to the entrance.

The return panel may contain the control operating panel (COP), phone box, and/or service panel.

The car door will slide behind the return panel.

For technical support on the E-Look Panel installation, please contact us at:

Elevator Cab Renovations
Office: (613) 745-4870
Toll Free: 1-877-745-4870
ecr@elevatorcabs.ca

Office Hours : 6:30 AM to 3:30 PM Eastern Standard Time



UNIVERSAL BAFFLE STRIP

TO BE UTILIZED WHEN ADDING
VENTILATION SLOTS TO AN
EXISTING CAB

INSTALLATION INSTRUCTION

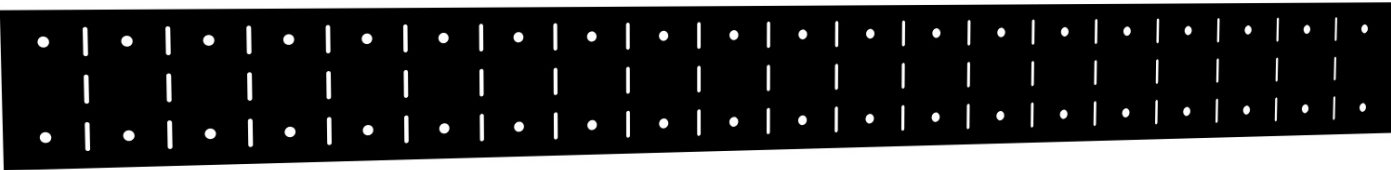

TOOLS REQUIRED

- Rivets (max dia 3.2mm) 1/8"
- or
- Screws (max dia 3.2mm) 1/8"
- Drill
- Rivet Gun

CAB COMPONENTS TO BE INSTALLED

Universal Baffle Strip(s) to be cut to size to suit shell opening(s)

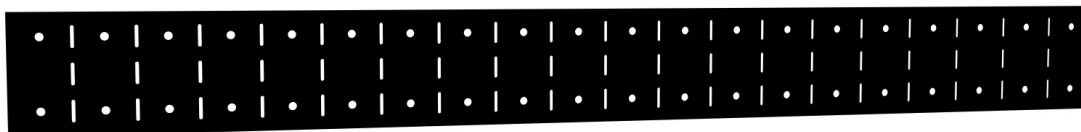

OVERVIEW

- 0.1. Included with your package is a universal baffle strip. The universal baffle strip is designed to be installed into open vent slots in the cab shell in order to prevent material passing through the vent slots into the hoist way (as per ASME-Av17.1/B-44). The universal baffle strip is intended to be installed from the cab shell interior, prior to the installation of the cab finishes. Please refer to the following instructions to properly install your universal baffle strip.

SECTION 1: PREPARE SITE FOR INSTALLATION

- 1.1. Once removal of the existing cab finishes are complete, determine if additional venting will be required.
- 1.2. If additional venting is required as per (as per ASME-A-17.1/B-44), locate and cut holes into the shell so that they will be hidden by the hollow vented kick plates (or hang on panels). Usually a 2'' (H) x 10'' (L) rectangular cut out is created off the finished floor for this purpose.
- 1.3. A typical side wall will have two cut-outs; a rear wall will have three cut outs.
- 1.4. Additional cut outs may also be required above the wall finishes close to the canopy (as per ASME-A-17.1/B-44).

For technical support on the Universal Baffle Strip installation, please contact us at:

Elevator Cab Renovations
Office: (613) 745-4870
Toll Free: 1-877-745-4870
ecr@elevatorcabs.ca

Office Hours : 6:30 AM to 3:30 PM Eastern Standard Time

SECTION 2: INSTALL UNIVERSAL BAFFLE STRIP

- 2.1. Begin by determining the span of the vent to be filled. The universal baffle strip is segmented; this allows the material to be bent inwards and outwards. Starting at one end, create a 90 degree bend in the strip followed by a 90 degree bend back (Dia .1).

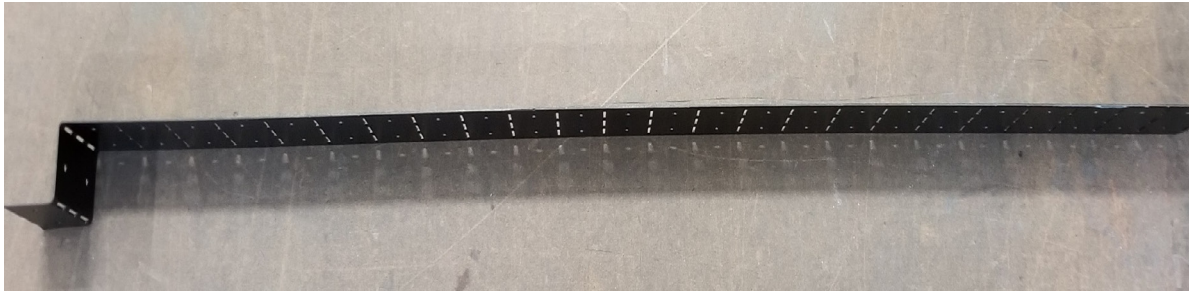

Dia .1

Universal baffle strip, one end bent

- 2.2. From this bend, follow the linkages until the span of the vent is reached (or as much as possible) and mirror the bends (Dia .2). Use more or less linkages to suit the style and depth of the vent holes.

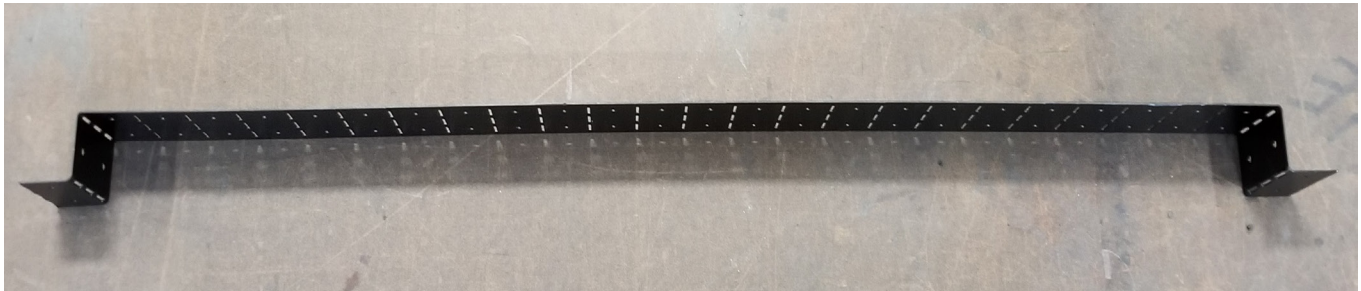

Dia .2

Universal baffle strip, both ends bent, excess trimmed

- 2.3. Trim the excess material and retain the remainder of the baffle strip for additional vents if applicable.

SECTION 2: INSTALL UNIVERSAL BAFFLE STRIP (Continued)

- 2.4. Fit the baffle strip into the vent slot (Dia .3) and secure to the cab shell with screws or rivets. (Dia .4)



Dia .3
Universal baffle strip ready for installation

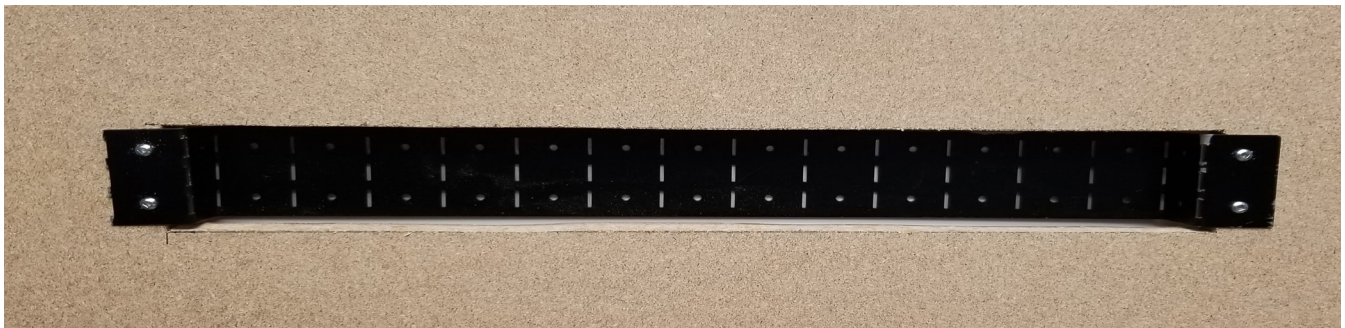

Dia .4
Universal baffle strip installed, secured with fasteners

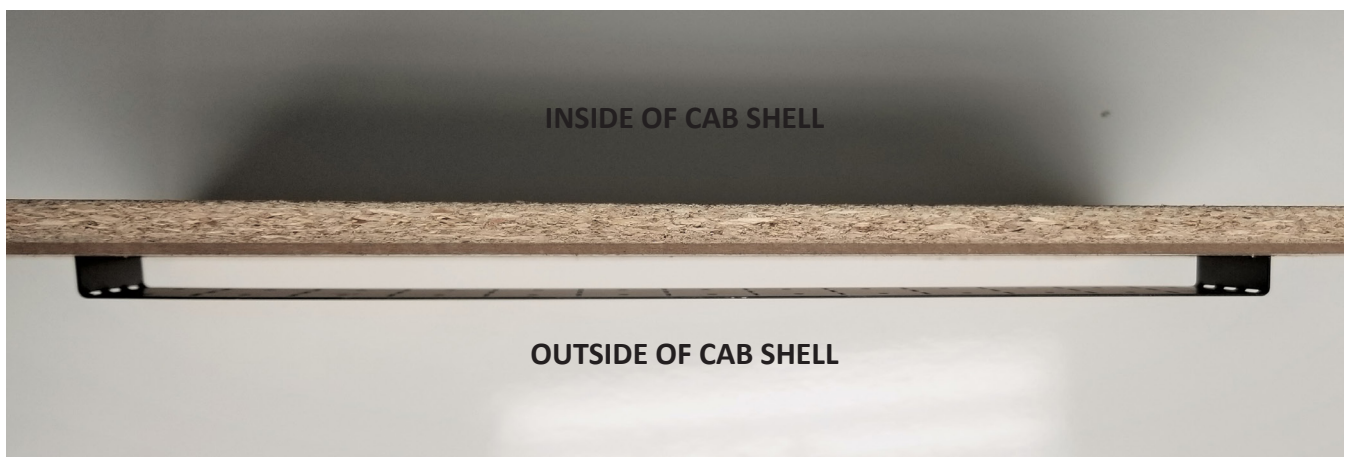

Dia .5
Section view of universal baffle strip

- 2.5. Once the vent slots and baffle strip are in place, proceed with installing the new cab finishes.